

RSP1 Ratchet Shears Instructions

Item Code 04276

- CUTS PE, ABS, PVC, CPVC, PVDF
(AND SIMILAR SOFT PLASTICS & RUBBER) MATERIAL.
- DOES NOT CUT METAL OR REINFORCED TUBING.

OPERATION:

Release the handle swing latch to separate handles. Depress the blade release to fully open the blade. Insert pipe or tubing squarely into the saddle. Squeeze the pivoting handle fully to engage the blade, then relax to allow ratcheting. Repeat until blade is through the pipe.

HELPFUL HINTS:

To prevent cracking of cold pipe - warm pipe (no direct flame) and use slow, even strokes. Apply light oil on mechanism to prevent rusting and reduce friction. Rotate shears slightly around very flexible thin pipe or tubing to assist in cutting.

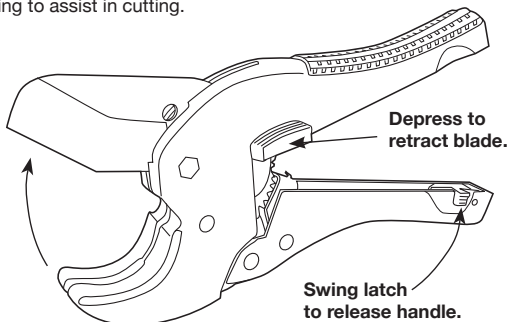

PIPE TOOLS & VISES
SINCE 1896

Reed Manufacturing Company

1425 West 8th Street

Erie, PA 16502 USA

Phone: 800-666-3691 or 814-452-3691

Fax: 800-456-1697 or 814-455-1697

www.reedmfgco.com

809 - #54277



PIPE TOOLS & VISES
SINCE 1896

Replacement Blade #94276

REPLACE BLADE:

Caution: Blade removal and replacement involves maneuvering and handling the loose blade. Use extreme caution when handling the blade.

Release the handle latch to separate handles. Depress the blade release to fully open the blade. Using small nosed pliers, gently remove the extension spring hook from the blade. Remove blade screw, wavy washer, and blade pivot nut from the opposite side. Carefully remove the blade from the body. Assemble the new blade into the body and replace blade pivot nut, screw and wavy washer. While making sure the blade is in the open position, carefully replace the extension spring hook into the blade hole. Test cut a piece of plastic pipe or tube to make sure of proper tool operation.

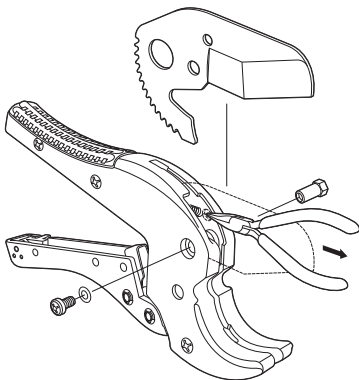

RESHARPEN BLADE:

Sharpen with fine, hard whetstone held at 30-degree angle to blade. Sharpen evenly on both sides of cutting edge so tool cuts easily. If blade cuts crooked, sharpen side toward which blade deflects. Draw stone into blade, not away.

CAUTION:

Wear eye protection when cutting cold or brittle plastics. Pipe can crack or shatter causing possible eye injury.



Keep fingers clear when cutting. Blade is sharp! Pick up and hold tool by the handles. When not using shears, leave blade in the fully advanced (closed) position to prevent damage to blade and hands. Latch handles together for storage.

QUALITY
& Service
that Last a Lifetime

809 - #54277